

-  Existing trees
-  Existing shrubs / hedge-row
-  Mown grass
-  New planting
-  Sand play
-  Impact absorbing surface
-  Existing rubber surface path
-  Existing benches

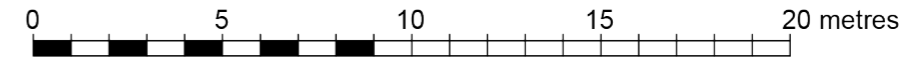

New group swing

New equipment that provides fun and challenge for a wide range of ages and abilities, such as a basket swing or hammock which can also provide for shared, sociable play and for more solitary, calmer moments

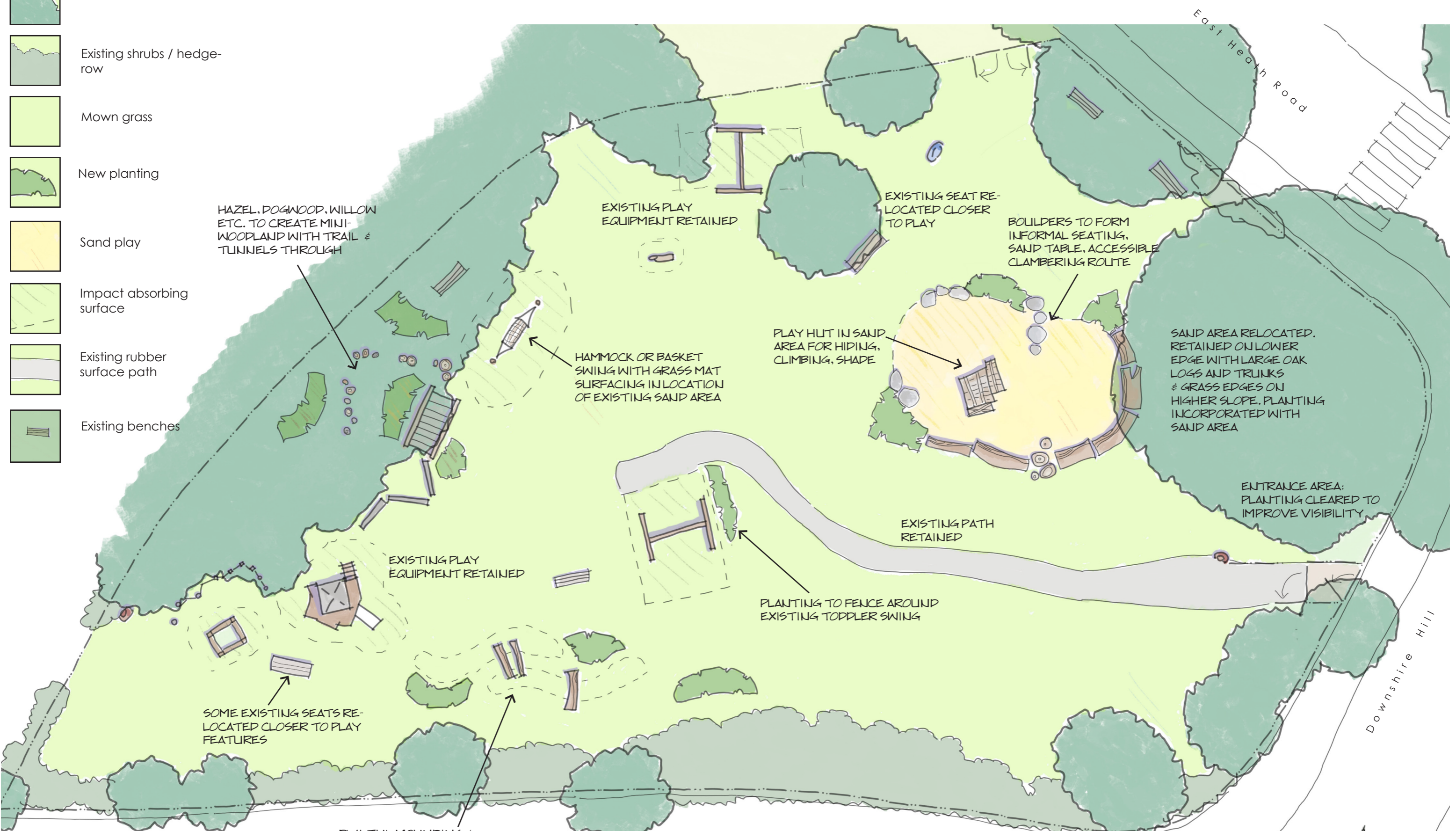

Equipment will be in natural colours & materials wherever possible in keeping with the natural setting of Hampstead Heath



New sand area

Natural edging to the re-located sand area of logs, boulders and grass are attractive, playable and practical, providing seating, sand tables, clambering and climbing and balancing opportunities with scope for imaginative play. Planting next to the sand area provides shade, close contact with nature whilst playing and softens the area into the space



Playing in nature

Low key natural interventions such as low mounds or ditches with routes, bridges across and natural planting to provide endless play opportunities



Sand play hut

A small 'hut' within the sand area provides somewhere to hide, a chance to climb and jump, a sand table for sand play or just somewhere to sit



Planting

New planting introduced will of native species or varieties of native species that are natural to the Heath, such as hazel, dogwood, willow, elder, wild grasses and flowers